

Facility Self-Screening Solution with Questionnaire Temperature Screening, Mask Detection and Customized Health Questionnaire

Businesses face new challenges as they reopen and resume full operations. A top priority is to protect their employees, visitors and customers while delivering a great customer experience. Hikvision's Facility Self-Screening Solution helps to reduce risk and protect people by offering a complete system that provides temperature screening, mask detection with alerts, and an automated, customized health questionnaire.

Designed to protect employees and visitors, the solution provides a streamlined process for access control, visitor reporting, and health status tracking.

System Topology



Product Showcase

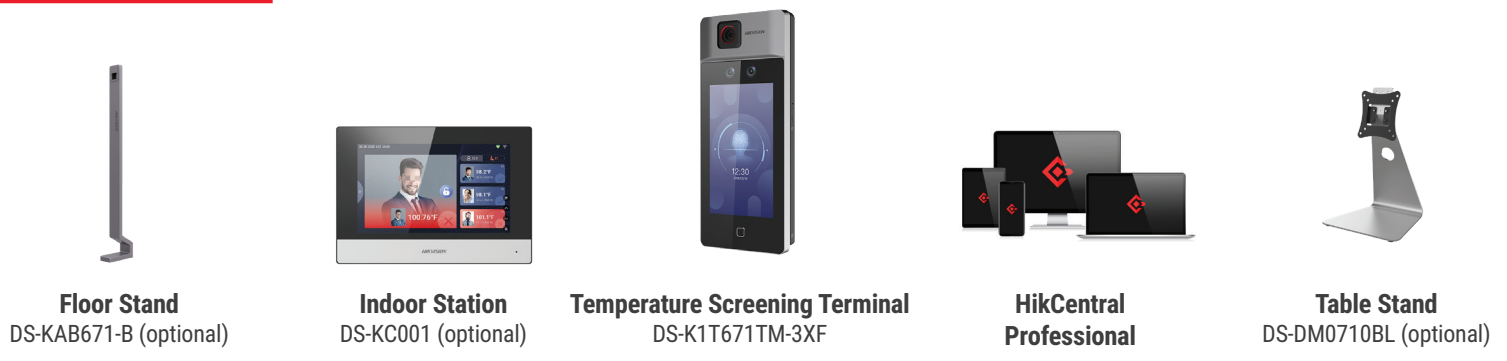

Model	Appearance	Deployment	LCD screen	Temperature range and accuracy	Measurement efficiency and distance	Mask detection
DS-K1T671TM-3XF		Wall mounting / floor standing with mounting pole	7 inch	86-113° F (±0.9° F) 30-45° C (±0.5° C)	0.2 seconds per person 0.98 to 6.5 ft (0.3 to 2.0 m)	✓

Hikvision Self-Screening Solution Benefits

Fast, Highly Accurate, Touchless Temperature Screening and Face Mask Detection

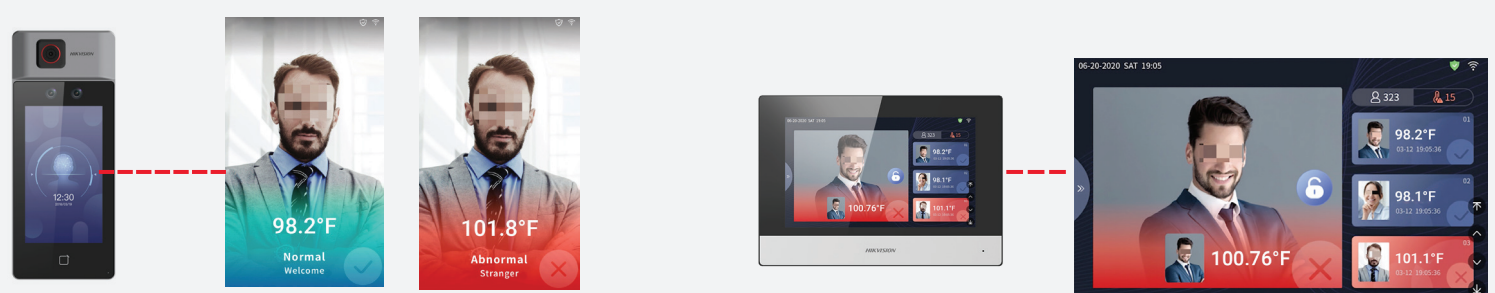

- Highly accurate thermographic temperature screening, ±0.9° F (±0.5° C)
- Mask detection
- Alarm prompts when abnormal temperature or no mask is detected
- Automated, touch-free sign-in experience

Customizable and Flexible: Questionnaire with Touchless Option

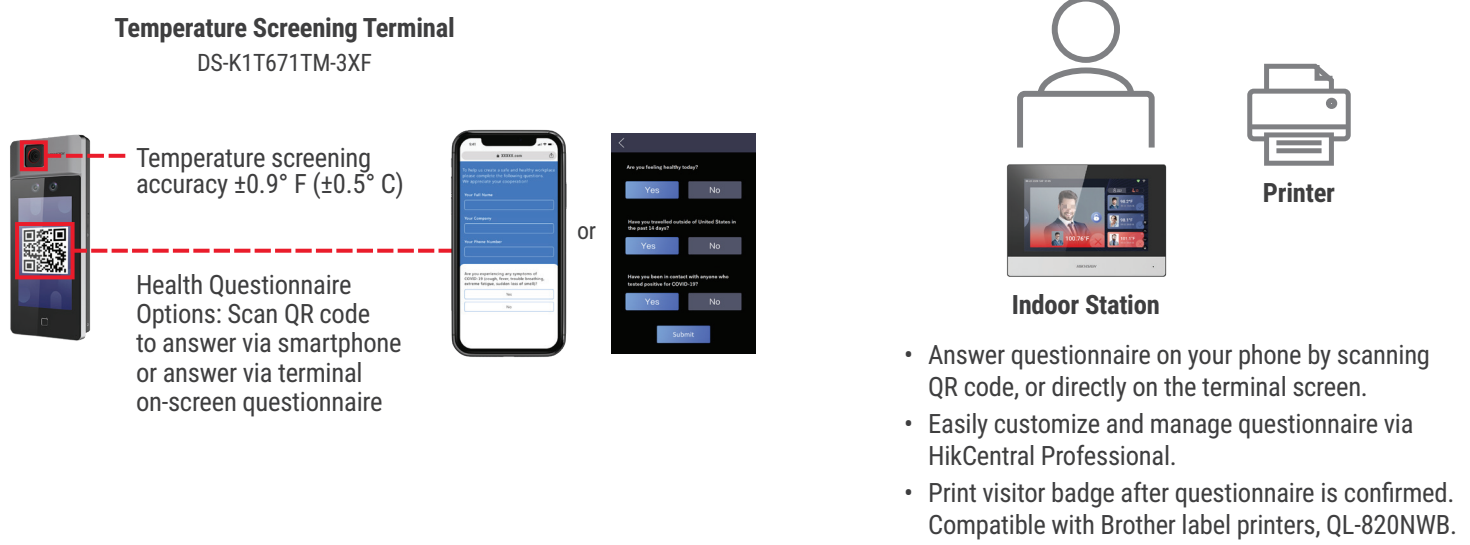

Employee & Visitor Data Management

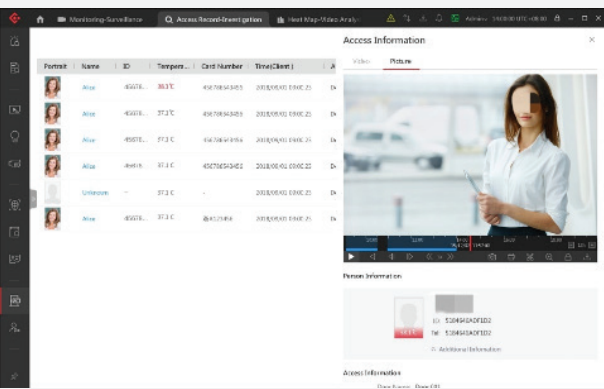

HikCentral Professional features:

- Temperature data storage
- Employee/Visitor report with questionnaire and temperature record
- Abnormal temperature trend analysis

Ideal For Multiple Applications

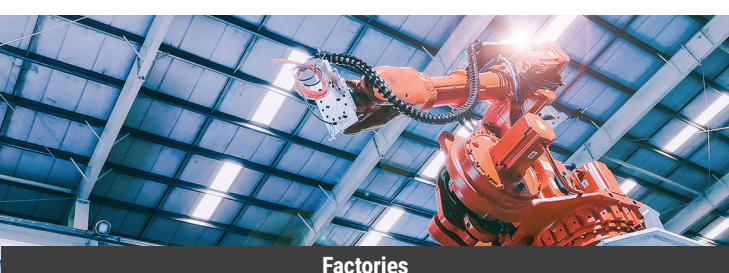
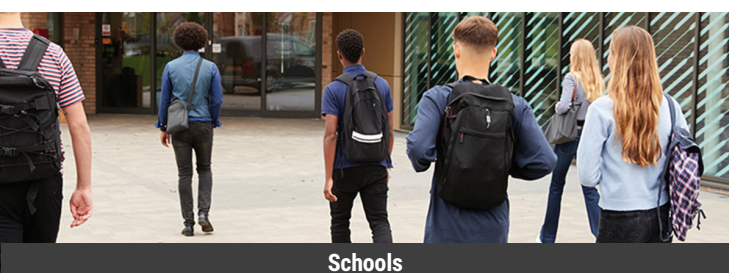

Please note:

- The solution must be installed indoors, out of direct sunlight, in a windless area.
- Hikvision's temperature screening thermographic cameras are designed to rapidly detect skin-surface temperatures in public areas from a safe distance
- Actual core body temperatures should be further confirmed using clinical measurement devices. Under all circumstances, Hikvision's thermographic cameras must be used in accordance with local laws and regulations.