

DS-2CD4324FWD-I(Z)(H)(S)

2MP Vandal-proof and Weather-proof Network Camera

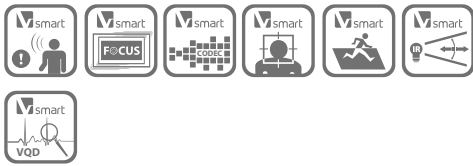

Key features

- Up to 1920 x 1080 high resolution
- Full HD 1080p video
- Smart Codec
- 120dB, 3D DNR
- Triple streams
- On-board storage, up to 64GB
- Smart Focus: Motorized VF lens (-Z)
- Smart VQD
- Smart Facial Detection
- Intrusion Detection
- Built-in heater & fan (-H)
- Defog
- 8~32mm Motorized VF lens optional
- People Counting

Dimensions

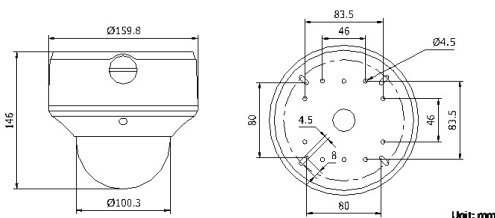

Available models

DS-2CD4324FWD-I, DS-2CD4324FWD-IZ,
 DS-2CD4324FWD-IH, DS-2CD4324FWD-IS,
 DS-2CD4324FWD-IZH, DS-2CD4324FWD-IHS,
 DS-2CD4324FWD-IZS, DS-2CD4324FWD-IZHS

* "-S" series support 1-ch audio I/O, 2-ch alarm I/O and 1-ch RS-485 interface

* "-Z" is equipped with Motorized VF lens

DS-2CD4324FWD-I(Z)(H)(S)	
Camera	
Image sensor	1/2.8" progressive scan CMOS
Min. illumination	0.02 lux@F1.2, AGC on, 0.027 lux@F1.4, AGC on, 0 lux with IR
Shutter time	1s ~ 1/100,000s
Slow shutter	Yes
Lens	2.8-12mm @ F1.4, angle of view: 113-33.8°
	-Z: 2.8-12mm @ F1.4, angle of view: 113-33.8°
	8-32mm @ F1.4, angle of view: 31.2°~10.2°
Lens mount	Φ14
Angle adjustment	Pan: 0° ~ 355°, tilt: 0° ~ 75°, rotation: 0° ~ 355°
Auto iris	DC drive
Day & night	ICR (Auto/Schedule/Alarm Trigger)
Digital noise reduction	3D DNR
Wide dynamic range	120dB
Compression standard	
Video compression	H.264 / MPEG4 / MJPEG
H.264 codec profile	Baseline profile / main profile / high profile
Video bit rate	32 Kbps ~ 16 Mbps
Audio compression	G.711/G.722.1/G.726/MP2L2
Audio bit rate	64Kbps(G.711) / 16Kbps(G.722.1) / 16Kbps(G.726) / 32-128Kbps(MP2L2)
Image	
Max. resolution	1920 x 1080
Frame rate	50Hz: 50fps(1920 x 1080, 1280 x 960, 1280 x 720)
	60Hz: 60fps (1920 x 1080, 1280 x 960, 1280 x 720)
3rd stream	Independent setting, up to:
	50Hz: 25fps (1920 x 1080), 60Hz: 30fps (1920 x 1080)
Image settings	Rotate mode, saturation, brightness, contrast, grayscale adjustable through client software or web browser
BLC	Yes, zone configurable
HLC	Yes
Defog	Yes
EIS	Yes
Picture overlay	128 x 128, BMP 24bit, zone configurable
ROI	Yes, up to 4 configurable areas for each of 3 streams
Network	
Network storage	NAS
Alarm trigger	Intrusion detection, Defocus detection, Motion detection, Face detection, line crossing detection, Dynamic analysis, Tampering alarm, Network disconnect, IP address conflict, Storage exception
Protocols	TCP/IP, ICMP, HTTP, HTTPS, FTP, DHCP, DNS, DDNS, RTP, RTSP, RTCP, PPPoE, NTP, UPnP, SMTP, SNMP, IGMP, 802.1X, QoS, IPv6, Bonjour (SIP optional)
Security	User authentication, watermark, IP address filtering, anonymous access, reset
System compatibility	ONVIF, PSIA, CGI
Interface	
Communication interface	1 RJ45 10M / 100M ethernet port
Video Output	1 Vp-p composite output (75 Ω/RCA, for lens adjustment when installation)
On-board storage	Built-in Micro SD/SDHC/SDXC slot, up to 64 GB
General	
Operating conditions	-30°C ~ 60°C (-22°F ~ 140°F), humidity 95% or less (non-condensing)
	-H: -40°C ~ 60°C (-40°F ~ 140°F), with smart heater on
Smart Heater	-H: support
Power supply	24 VAC ± 10%, PoE (802.3at)
Power consumption	Max. 13.5 W
IR range	Approx. 10 to 30 meters
Ingress protection	IP66
Impact protection	IEC60068-2-75Eh, 50J; EN50102, up to IK10
Dimensions	Φ 159.8 x 146 mm (Φ 6.29" x 5.75")
Weight	2100 g (4.62 lbs)