

Title:	DS-PEA How to configure Master Station Call Forwarding	Version:	v1.0	Date:	07/04/2019
Product:	DS-PEA Series Emergency Alarm Device			Page:	1 of 6

Preparation

1. DS-PEA1-21 Panic Alarm Station, DS-PEA4L-7 Panic Alarm Master Station
2. Professional Client iVMS-4200 2.7.4.5

DS-PEA How to configure Master Station Call Forwarding

When you want use Master Station Call Forwarding, you need connect **two** DS-PEA1-21 and **one** DS-PEA4L-7 to main master station DS-PEA4L-7 by SIP server at first.

Then configure Master Station Call Forwarding in main master station.

1. Main master station configuration

Step 1: Click **Configuration > Device > Device** to enter the device configuration interface. Then hold on Device Name for 3s, like 4.

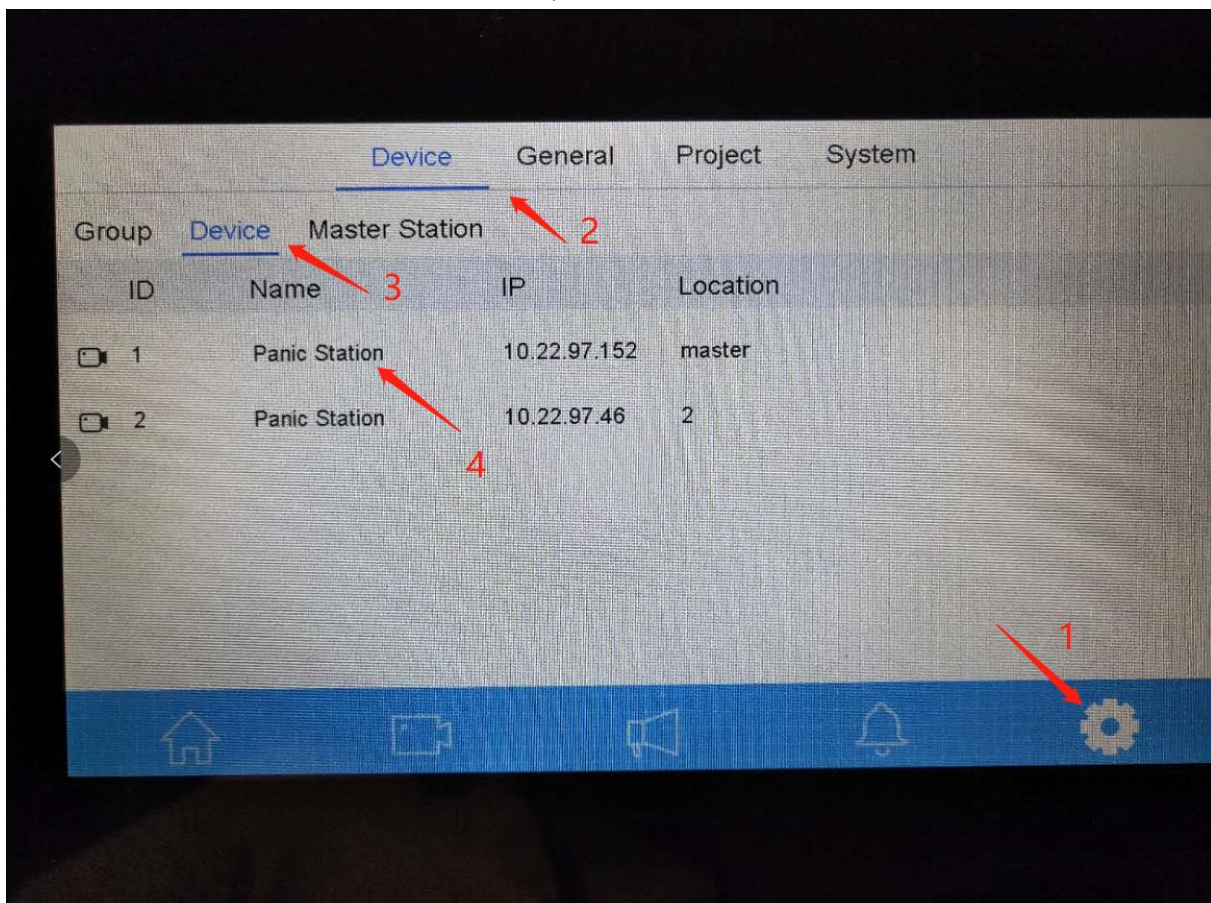

Title:	DS-PEA How to configure Master Station Call Forwarding	Version:	v1.0	Date:	07/04/2019
Product:	DS-PEA Series Emergency Alarm Device			Page:	2 of 6

Step 2: Click **Advance Settings**.

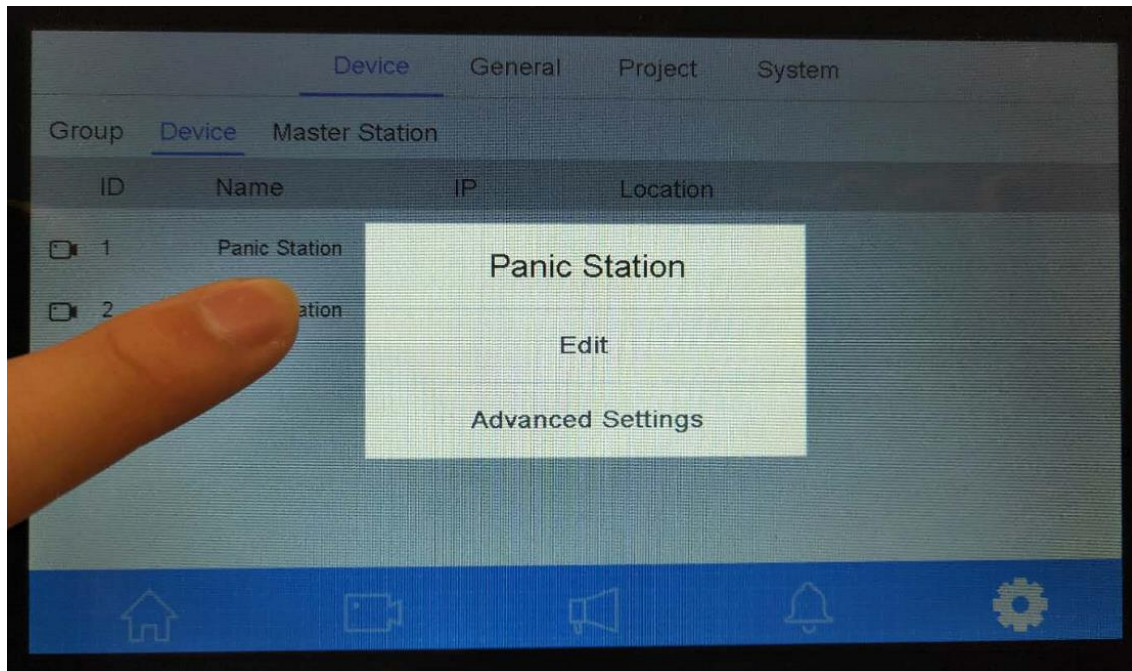

Step 3: Enable **Call Forwarding**, then configure First Priority and Second Priority.

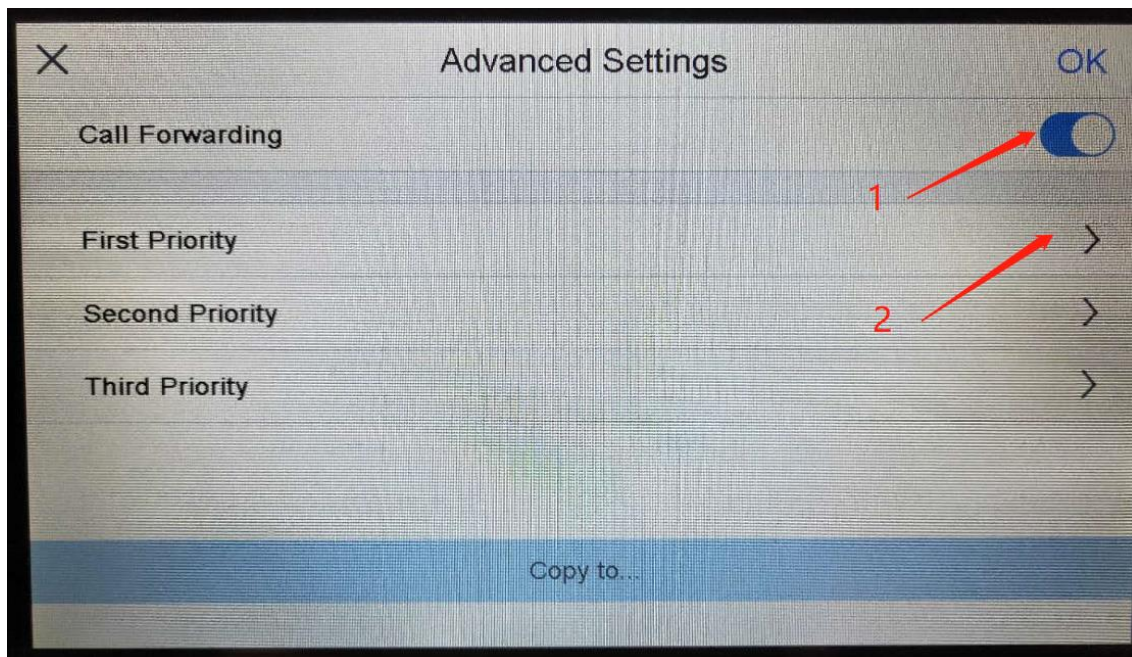

Title:	DS-PEA How to configure Master Station Call Forwarding	Version:	v1.0	Date:	07/04/2019
Product:	DS-PEA Series Emergency Alarm Device			Page:	3 of 6

Step 4: First Priority---Select Main Master Station IP.

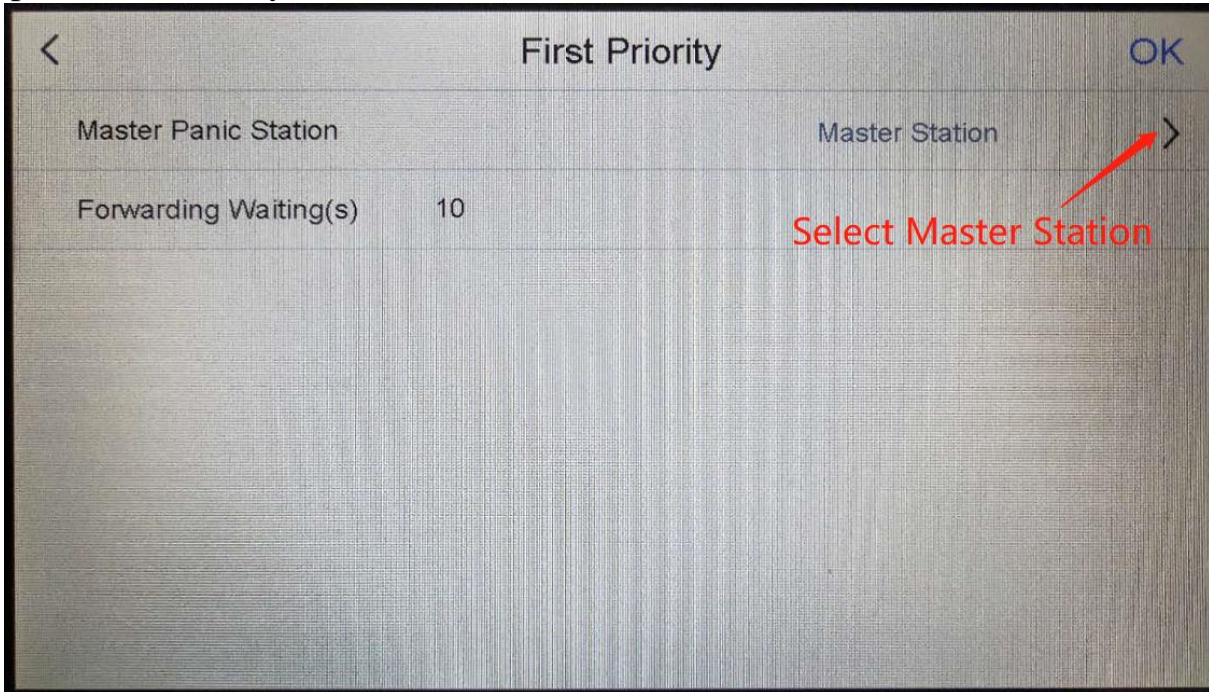

Click ✓ and click OK to save configuration.

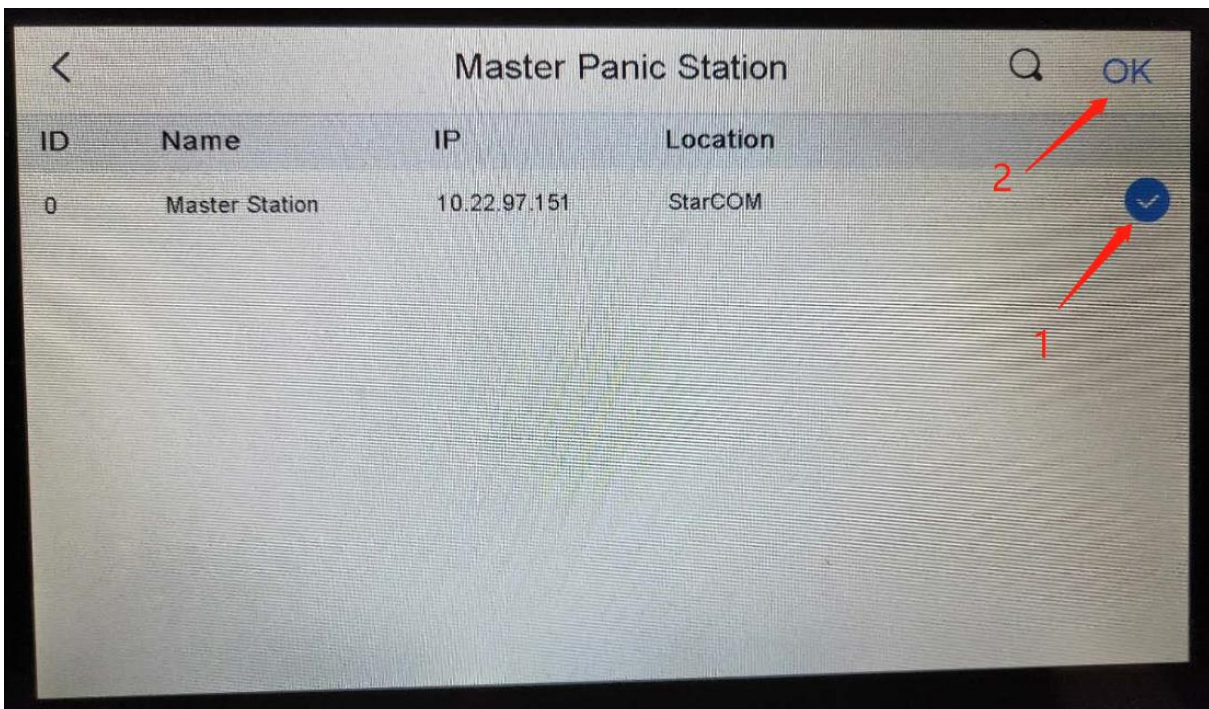

Title:	DS-PEA How to configure Master Station Call Forwarding	Version:	v1.0	Date:	07/04/2019
Product:	DS-PEA Series Emergency Alarm Device			Page:	4 of 6

Step 4: Second Priority---Select Second Master Station IP.

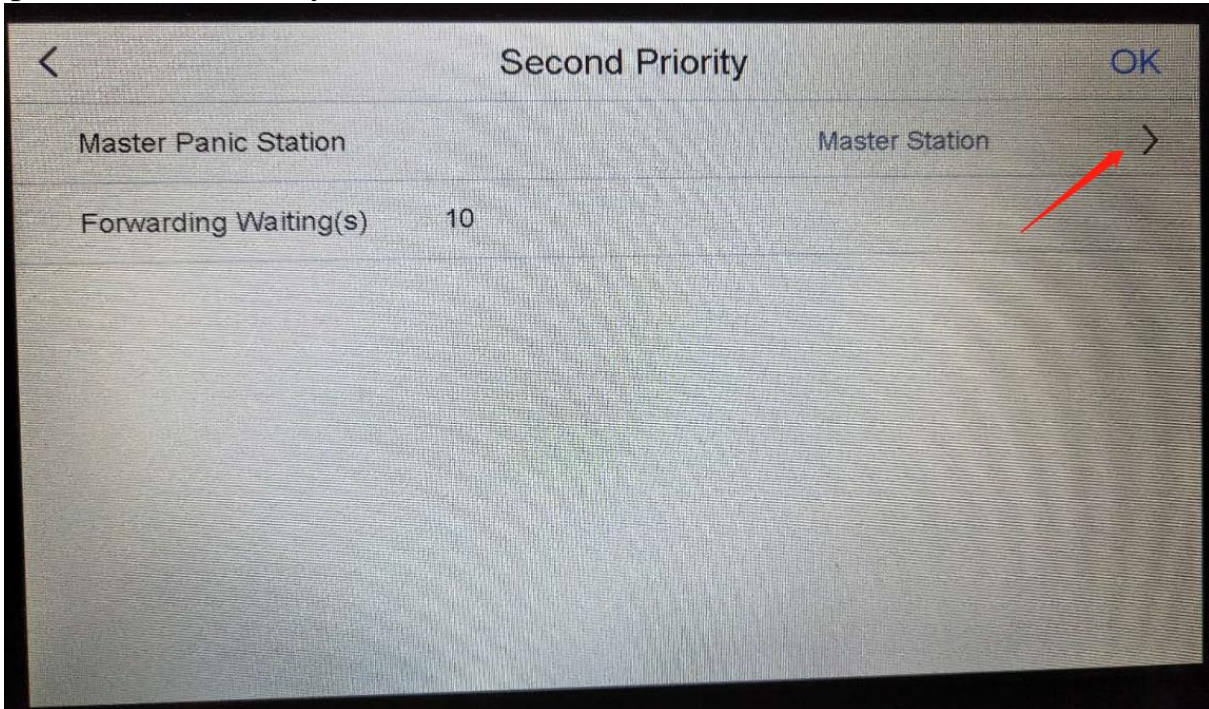

Click “√” and click OK to save configuration.

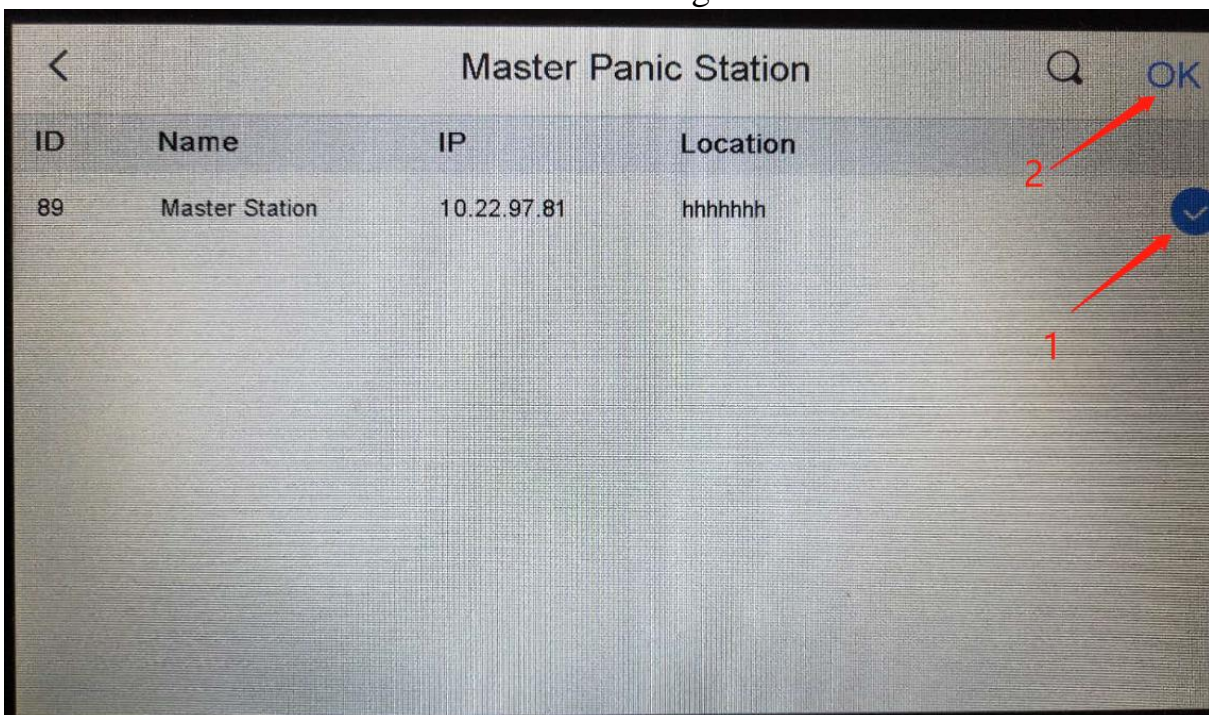

Title:	DS-PEA How to configure Master Station Call Forwarding	Version:	v1.0	Date:	07/04/2019
Product:	DS-PEA Series Emergency Alarm Device			Page:	5 of 6

2. Example

DS-PEA1-21: Device A, Device B; DS-PEA4L-7: Master station C, Master station D
Master station C is main station, Master station D is second station.

Registered all device to Master station C by SIP.

Example 1: Click Device A panic button, call Master station C. Master Station C don't answer the call, wait 10s, will call Master station D.

Example 2: Click Device A panic button, call Master station C. Master Station C click waiting button, it will call Master Station D.

Example 3: Click Device A panic button, call Master station C. Master Station C answer the call. At the same time click device B panic button, it will call Master Station D.

Video address: Emergency Call Forwarding.wmv

[ftp://hikftp.hikvision.com:400/Product%20File\(Overseas\)/20%20Alarm/Hikvision/11%20Installation&How%20to/Video/](ftp://hikftp.hikvision.com:400/Product%20File(Overseas)/20%20Alarm/Hikvision/11%20Installation&How%20to/Video/)



Title:	DS-PEA How to configure Master Station Call Forwarding	Version:	v1.0	Date:	07/04/2019
Product:	DS-PEA Series Emergency Alarm Device			Page:	6 of 6

First Choice for Security Professionals
HIKVISION Technical Support