

## IPC-B169HA 6 MP ColorVu Fixed Bullet Network Camera

### ColorVu



Hikvision ColorVu technology provides 24/7 vivid colorful images with F1.0 advanced lenses and high performance sensors. F1.0 super-aperture collects more light to produce brighter images. Advanced sensor technology can vastly improve the utilization of available light.

- High quality imaging with 6 MP resolution
- 24/7 colorful imaging
- Support Human and Vehicle Detection
- Water and dust resistant (IP67)
- Efficient H.265+ compression technology

## ▪ Specification

| Camera                   |  |
|--------------------------|--|
| Image Sensor             | 1/2.4" Progressive Scan CMOS   |
| Max. Resolution          | 3200 × 1800  |
| Min. Illumination        | Color: 0.001 Lux @ (F1.0, AGC ON), 0 Lux with light  |
| Shutter Time             | 1/3 s to 1/100,000 s   |
| Day & Night              | 24/7 color imaging   |
| Angle Adjustment         | Pan: 0° to 360°, tilt: 0° to 90°, rotate: 0° to 360°   |
| Lens                     |  |
| Lens Type                | Fixed focal lens, 2.8 and 4 mm optional  |
| Focal Length & FOV       | 2.8 mm, horizontal FOV: 117°, vertical FOV: 64°, diagonal FOV: 138°<br>4 mm, horizontal FOV: 82°, vertical FOV: 45°, diagonal FOV: 95°       |
| Lens Mount               | M12  |
| Iris Type                | Fixed  |
| Aperture                 | F1.0   |
| Depth of Field           | 2.8 mm: 2 m to ∞<br>4 mm: 3.1 m to ∞   |
| DORI                     |  |
| DORI                     | 2.8 mm, D: 64 m, O: 25 m, R: 12 m, I: 6 m<br>4 mm, D: 92 m, O: 36 m, R: 18 m, I: 9 m   |
| Illuminator              |  |
| Supplement Light Type    | White Light  |
| Supplement Light Range   | Up to 30 m   |
| Smart Supplement Light   | Yes  |
| Video                    |  |
| Main Stream              | 50 Hz:<br>20 fps (3200 × 1800, 2688 × 1520, 1920 × 1080, 1280 × 720)<br>60 Hz:<br>20 fps (3200 × 1800, 2688 × 1520, 1920 × 1080, 1280 × 720) |
| Sub-Stream               | 50 Hz: 20 fps (1280 × 720, 640 × 480, 640 × 360)<br>60 Hz: 20 fps (1280 × 720, 640 × 480, 640 × 360)   |
| Video Compression        | Main stream: H.265+/H.265/H.264+/H.264,<br>Sub-stream: H.265/H.264/MJPEG   |
| Video Bit Rate           | 32 Kbps to 16 Mbps   |
| H.264 Type               | Baseline Profile, Main Profile, High Profile   |
| H.265 Type               | Main Profile   |
| Bit Rate Control         | CBR, VBR   |
| Region of Interest (ROI) | 1 fixed region for main stream   |
| Network                  |  |
| Protocols                | TCP/IP, ICMP, DHCP, DNS, DDNS, HTTP, RTP, RTSP, NTP, IGMP, IPv6, UDP, QoS, FTP, SMTP, UPnP   |
| Simultaneous Live View   | Up to 6 channels   |
| API                      | Open Network Video Interface (Profile S), ISAPI, SDK   |
| User/Host                | Up to 32 users<br>3 user levels: administrator, operator, and user   |

|                                  |  |
|----------------------------------|--|
| Security                         | Password protection, complicated password, watermark, basic and digest authentication for HTTP, WSSE and digest authentication for Open Network Video Interface, security audit log, host authentication (MAC address) |
| Client                           | iVMS-4200, HiLookVision  |
| Web Browser                      | Plug-in required live view: IE 10, IE 11,<br>Local service: Chrome 57.0+, Firefox 52.0+, Edge 89+  |
| <b>Image</b>                     |  |
| Image Settings                   | Rotate mode, saturation, brightness, contrast, sharpness, gain, white balance, adjustable by client software or web browser  |
| Day/Night Switch                 | Day, Night, Auto, Schedule   |
| Wide Dynamic Range (WDR)         | 120 dB   |
| SNR                              | ≥ 52 dB  |
| Image Enhancement                | BLC, HLC, 3D DNR   |
| Privacy Mask                     | 4 programmable polygon privacy masks   |
| <b>Interface</b>                 |  |
| Ethernet Interface               | 1 RJ45 10 M/100 M self-adaptive Ethernet port  |
| <b>Event</b>                     |  |
| Basic Event                      | Motion detection (support alarm triggering by specified target types (human and vehicle)), video tampering alarm, exception  |
| Linkage                          | Upload to FTP, notify surveillance center, send email, trigger capture   |
| <b>General</b>                   |  |
| Power                            | 12 VDC ± 25%, 0.43 A, max. 5.3 W, Ø5.5 mm coaxial power plug, reverse polarity protection,<br>PoE: IEEE 802.3af, Class 3, max. 6.5 W   |
| Material                         | Aluminum alloy body  |
| Dimension                        | Ø76.6 mm × 164.4 mm (Ø3" × 6.5")   |
| Package Dimension                | 234 mm × 120 mm × 117 mm (9.2" × 4.7" × 4.6")  |
| Weight                           | Approx. 425 g (0.9 lb.)  |
| With Package Weight              | Approx. 633 g (1.4 lb.)  |
| Storage Conditions               | -30 °C to 60 °C (-22 °F to 140 °F). Humidity 95% or less (non-condensing)  |
| Startup and Operating Conditions | -30 °C to 60 °C (-22 °F to 140 °F). Humidity 95% or less (non-condensing)  |
| Language                         | English, Ukrainian   |
| General Function                 | Heartbeat, anti-banding, mirror, password protection, password reset via email   |
| <b>Approval</b>                  |  |
| EMC                              | CE-EMC: EN 55032:2015+A1:2020, EN 50130-4:2011+A1:2014, EN IEC 61000-3-2:2019+A1:2021, EN 61000-3-3:2013+A1:2019+A2:2021,<br>RCM: AS/NZS CISPR 32: 2015,<br>KC: KN32: 2015, KN35: 2015                                 |
| Safety                           | CB: IEC 62368-1: 2014+A11,<br>CE-LVD: EN 62368-1: 2014/A11: 2017   |
| Environment                      | CE-RoHS: 2011/65/EU,<br>WEEE: 2012/19/EU,<br>Reach: Regulation (EC) No 1907/2006   |
| Protection                       | IP67: IEC 60529-2013   |

## ▪ Available Model

IPC-B169HA (2.8/4 mm)

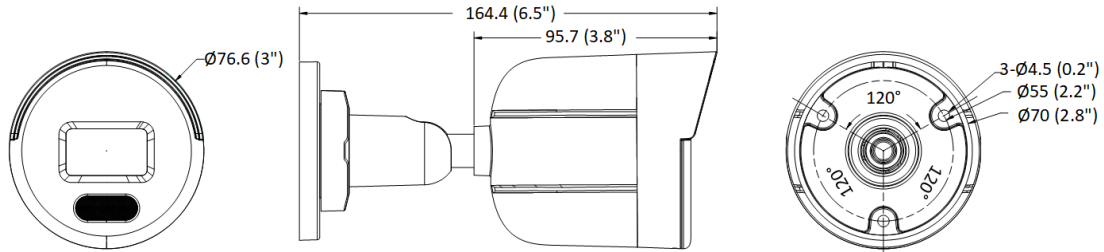

## ▪ Dimension



Unit: mm (inch)

## ▪ Accessory

### ▪ Optional

| DS-1276ZJ-SUS<br>Corner Mount   | DS-1275ZJ-SUS<br>Vertical Pole Mount  | DS-1280ZJ-XS<br>Junction Box  |
|---|---|---|
|  |  |  |



### Headquarters

No.555 Qianmo Road, Binjiang District,  
Hangzhou 310051, China  
T +86-571-8807-5998  
Technical Support: support@hikvision.com

Follow us on social media to get the latest product and solution information.



Hikvision



HikvisionHQ



HikvisionHQ



Hikvision\_Global



Hikvision  
Corporate Channel



hikvisionhq